

PEUGEOT 205

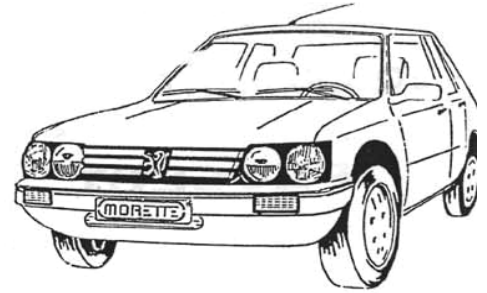

ASSEMBLING INSTRUCTION

- 1°) REMOVE : the grill, the sealed-beams with brackets, the indicators
the sealing rubber of the bumper
- 2°) TAKE OFF (GTI) the horn which obstructs ; put it on the bolt of the bumper bracket, radiator side
- 3°) CUT the garnish moulding of the bumper
(length 240 and 383 of the rough drawing)
CUT the places of the indicators into the bumper
(size regarding to the diagram and the former supplied)
- 4°) DRILL the holes $\varnothing 3$ mm through
the indicators brackets
- 5°) HOLD the indicators brackets
(letter H on the top)
- 6°) CONNECT the indicators wires
- 7°) DRILL the holes $\varnothing 6$ mm
- 8°) PLACE the equipment "PLEIN JOUR"
- 9°) HOLD the rear mounting eyes
- 10°) CHECK the place regarding to the wing
- 11°) DRAW the points of the upper fixing,
DRILL $\varnothing 3$ mm and HOLD

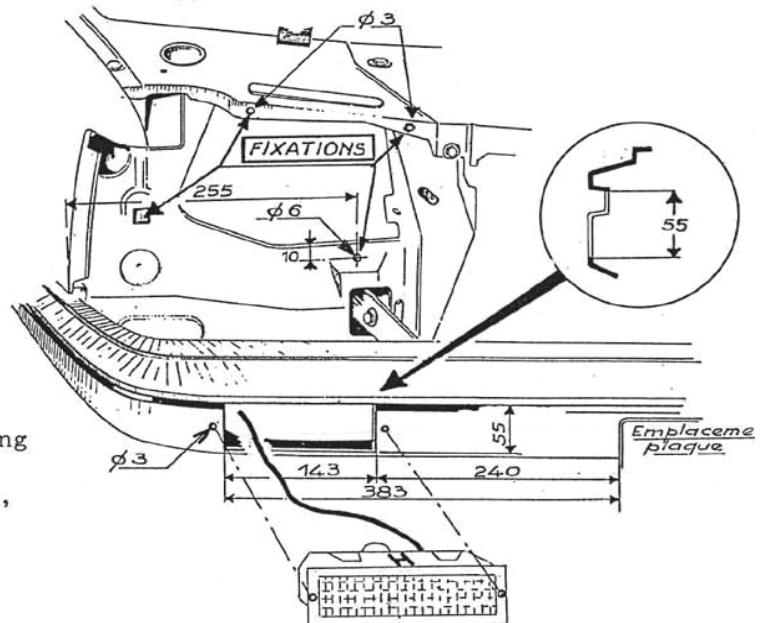

12°) ELECTRICAL CONNECTION

IMPORTANT : YOU MUST HOLD WELL THE SEALED-BEAMS TO INSERT THE CABLE PLUGS

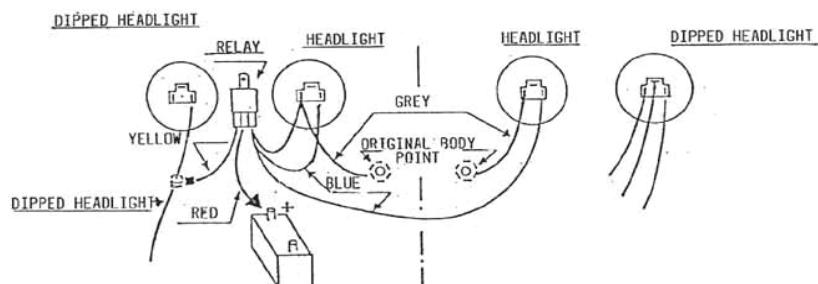

- 13*) ADJUSTE the headlights with the white nuts
ON THE ASSEMBLING 4 H1 (HELLA)

LARGE YELLOW WIRE : on the H1 headlight bulb,
right side

YELLOW WIRE and WHITE WIRE WITH LARGE FLAT PLUG :
into the original cable plugs

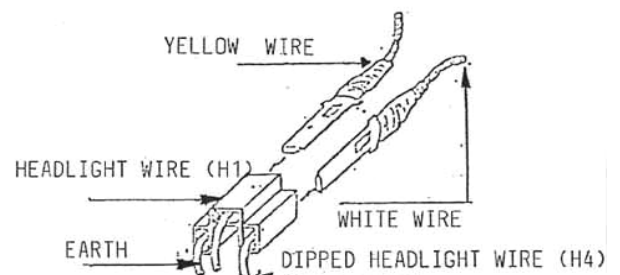

TWIN HEADLAMPS « PLEIN JOUR® »

Morette

PEUGEOT 205 with indicators in bumper

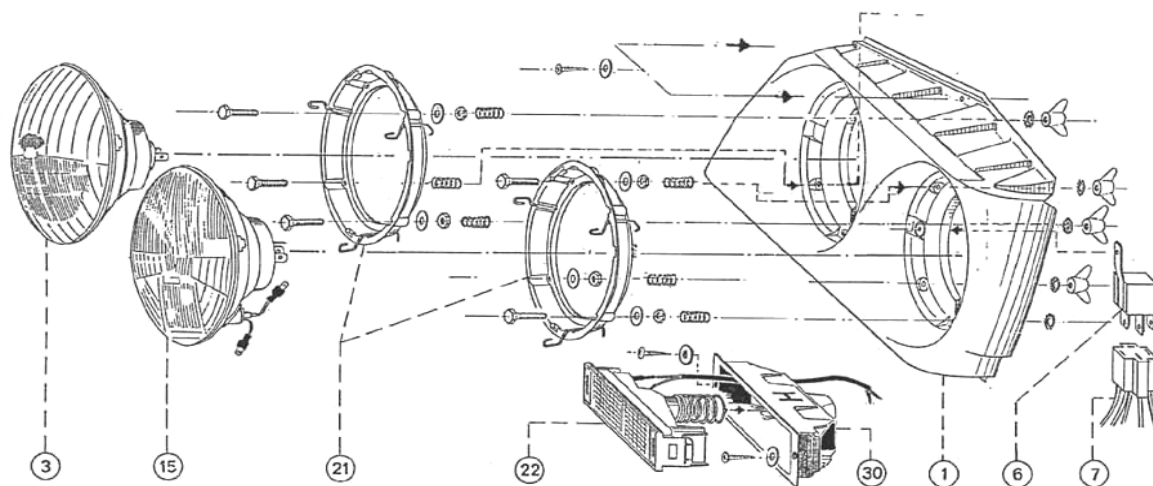

N	DESCRIPTION	PART. REF.
	FULL KIT H4 + H1 RIGHT HAND DRIVE	008 424 000
	FULL KIT H4 + H1 LEFT HAND DRIVE	008 422 000
1	LEFT MASK	8 420 011
1	RIGHT MASK	8 420 012
3	OPTIC H1 CIBIE	8 252 030
6	RELAY	9 760 060
7	ELECTRICAL WIRINGS	8 420 070
15	OPTIC H4 CIBIE (right hand drive)	8 284 150
15	OPTIC H4 CIBIE (left hand drive)	8 280 150
21	CROWN WITH CLIPS AND SCREW	8 252 210
22	INDICATOR LIGHT LEFT/RIGHT	8 420 220
30	INDICATOR BRACKET LEFT/RIGHT	8 420 300

SAFRI 16 rue Sadi Carnot BP 35 76710 MONTVILLE FRANCE
TEL (33)35 33 48 48 FAX (33) 35 33 89 00

E-mail: info@morette.com / web site : www.morette.com